

PROGRAM

66th Annual Meeting of the Northeastern Weed Science Society

***THEME: Weed Science Funding:
New Avenues for a Changing
Landscape***



**Sheraton Society Hill Hotel
Philadelphia, PA**

January 3 - 6, 2012



**Annual Meeting of Northeast Region –
American Society for Horticultural Science**

Meeting Location

**Sheraton Society Hill Hotel
One Dock Street
Philadelphia, PA 19106
(215) 238-6000**

Hotel Website

www.sheraton.com/societyhill

Room Registration Website

**[66th Annual Meeting of the Northeastern Weed
Science Society](#)**

**DOWNLOAD PRESENTATIONS AT
REGISTRATION DESK**

USB DRIVES REQUIRED

**Deadline for Downloading
Presentations:**

***NEWSS Graduate Students*
Tuesday Jan 3rd 6:30 p.m.**

***All Other NEWSS Presentations*
Wednesday Jan 4th 8:45 a.m.**

Prefunction Lobby



The Northeastern Weed Science Society
P.O. Box 307
Fredericksburg, PA 17026
www.NEWSS.org

Platinum Level



Bayer CropScience

Gold Level



Dow AgroSciences

Silver Level



BAAR Scientific LLC

Partners
with
solutions



An Employee-Owned Company

Bronze Level

ACDS Research

Reality research

LABServices

Meeting Location

Sheraton Society Hill Hotel

One Dock Street

Philadelphia, PA 19106

(215) 238-6000

Directions and Transportation

Shuttle from airport available through Lady Liberty Shuttle Service: <http://www.ladylibertyshuttle.com/>

From Philadelphia International Airport (South)

Take Interstate 95 North to Exit 20 (Columbus Boulevard). Turn left at the traffic light onto Columbus. Turn left turn at the sixth light, for Dock Street. Turn right at the stop sign. The hotel is on the right-hand side.

From East

Take Ben Franklin Bridge from Camden, stay in the right lane. Take the first right off of bridge to Sixth Street then follow Sixth Street to Market Street and turn left. Follow Market to Second Street and turn right. Follow Second Street to Dock Street and the hotel is on the left.

From North

Take Interstate 95 South to Exit 20 (Columbus Boulevard). At the bottom of the ramp, turn left onto Columbus Boulevard. Follow for 3 traffic lights to Dock Street and turn left. Continue to a dead end and turn right. The hotel will be on the right.

From West

Take Pennsylvania Turnpike to 76 East (Exit 326 - Valley Forge). Follow 76 East to 676 East (Exit 344 - Central Philadelphia). Continue on 676 East to Interstate 95 South. Take I-95 South to Penn's Landing (Exit 20). At the bottom of the ramp, turn left onto Columbus Boulevard. Follow to Dock Street and turn left. Continue to the dead end and turn right. The hotel is on the right-hand side.

Make Plans for the 2013 Joint Meeting with WSSA:

February 4 - 7, 2013

Monday through Thursday

Location: Hilton, Baltimore, MD

Sheraton Society Hill Hotel Floor Plan

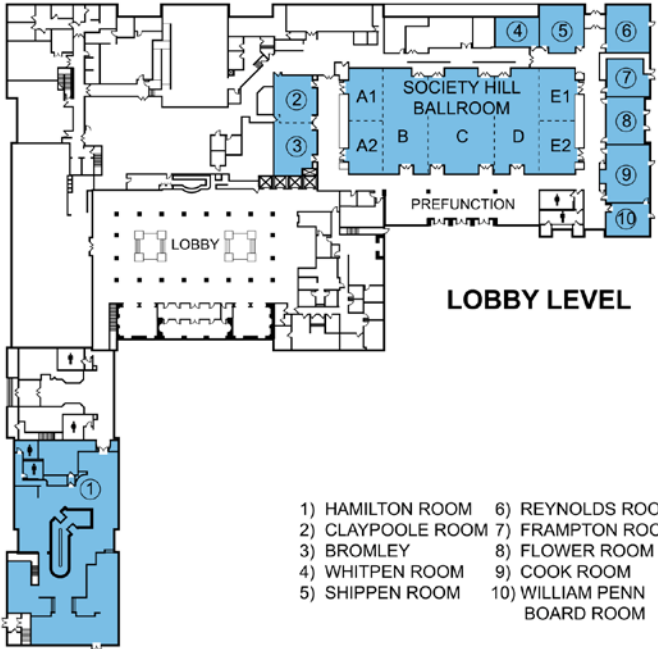

NORTHEASTERN WEED SCIENCE SOCIETY

www.NEWSS.org

**Sheraton Society Hill Hotel
Philadelphia, PA**

EXECUTIVE COMMITTEE OFFICERS

- President** **M.J. VanGessel**
University of Delaware
16483 County Seat Highway
Georgetown, DE 19947
mjv@udel.edu
- President-Elect** **A. DiTommaso**
Cornell University
903 Bradfield Hall
Ithaca, NY 14853
ad97@cornell.edu
- Vice-President** **D.D. Lingenfelter**
Penn State University
116 ASI Building
University Park, PA
dxl18@psu.edu
- Secretary/Treasurer** **M.A. Bravo**
Pennsylvania Department of
Agriculture
2301 North Cameron Street
Harrisburg, PA 17110
mab36@psu.edu
- Past President** **H.A. Sandler**
UMass Cranberry Station
P.O. Box 569
East Wareham, MA 02538
hsandler@umext.umass.edu

COMMITTEES

Editor

D.W. Lycan

Syngenta Lawn and Garden
18 Appleridge St.

Baldwinsville, NY 13027

darren.lycan@syngenta.com

Public Relations

B.A. Scott

University of Delaware

16483 County Seat Highway

Georgetown, DE 19947

bascott@udel.edu

Research & Education Coordinator

J.B. Willis

Monsanto Company

1305 Sanders Road

Troy, OH

john.b.willis@monsanto.com

Sustaining Membership

J.H. O'Barr

BASF Corporation

106 Whippoorwill Lane

Hummelstown, PA 17036

john.obarr@basf.com

CAST Representative

R.G. Probst

University of Massachusetts

Bowditch Hall, Rm 206

Amherst, MA 01003

rprobst@umext.umass.edu

Graduate Student Representative

A.N. Smith

Virginia Tech

435 Old Glade Road

Blacksburg, VA 24061

urzsmith@vt.edu

WSSA Representative

J.N. Barney

Virginia Tech

435 Old Glade Road

Blacksburg, VA 24061

jnbarney@vt.edu

COMMITTEE MEETINGS

EXECUTIVE COMMITTEE MEETINGS

Tuesday, January 3

2:00 p.m. - 4:30 p.m. William Penn Boardroom

Friday, January 6

Executive Committee (Old and New)

7:00 a.m. - 7:30 a.m. Breakfast, Lounge

7:30 a.m. - 8:15 a.m. Meeting,
Cook Room

AWARDS COMMITTEE MEETING

Tuesday, January 3

5:00 p.m. - 5:30 p.m. Flower Room

WEED SCIENCE FIELD DAY COMMITTEE

Tuesday, January 3

5:00 p.m. - 5:15 p.m. William Penn Boardroom

COLLEGIATE WEED CONTEST COMMITTEE

Tuesday, January 3

5:15 p.m. - 6:00 p.m. William Penn Boardroom

PROGRAM COMMITTEE MEETING

Tuesday, January 3

5:30 p.m. - 6:00 p.m. Cook Room
(Moderators, Section
Chairs, Chairs-Elect)

AUDIT COMMITTEE

Tuesday, January 3

6:30 p.m. - 7:00 p.m. Registration Desk

**STUDENT PAPER JUDGING
COMMITTEE MEETING**

Tuesday, January 3

5:30 p.m. - 6:00 p.m. Flower Room

Wednesday, January 4

5:30 p.m. - 6:30 p.m. Flower Room

Thursday, January 5

11:30 a.m. - 1:00 p.m. Taste Restaurant

PHOTO JUDGING COMMITTEE MEETING

Tuesday, January 3

6:00 p.m. - 7:00 p.m. William Penn Boardroom

POSTER JUDGING COMMITTEE MEETING

Wednesday, January 4

7:30 a.m. Ballroom A&B

NEASHS BUSINESS MEETING

Wednesday, January 4

4:45 p.m. - 5:45 p.m. Bromley/Claypoole

**PAST PRESIDENTS' BREAKFAST
MEETING**

Thursday, January 5

7:00 a.m. - 7:30 a.m. Breakfast, Taste

7:30 a.m. - 8:15 a.m. Meeting,
Taste Restaurant

NEWSS REGISTRATION

Tuesday, January 3

4:30 p.m. - 6:30 p.m. Prefunction Lobby

Wednesday, January 4

7:30 a.m. - 4:00 p.m. Prefunction Lobby

Thursday, January 5

8:00 a.m. - 3:00 p.m. Prefunction Lobby

Friday, January 6

8:00 a.m. - 11:00 a.m. Prefunction Lobby

NEASHS REGISTRATION

Tuesday, January 3

4:30 p.m. - 6:30 p.m. Prefunction Lobby

Wednesday, January 4

7:30 a.m. - 10:00 a.m. Prefunction Lobby

Thursday, January 5

8:00 a.m. - 9:00 a.m. Prefunction Lobby

**Please download your presentations
at the Registration Desk when you
register at the meeting!!**

USB memory sticks required

**Deadline for Downloading NEWSS
Presentations:**

***NEWSS Graduate Students
Tuesday 6:30 p.m.***

***All Other NEWSS Presentations
Wednesday 8:45 a.m.***

CONDENSED PROGRAM

TUESDAY JANUARY 3

- 2:00 p.m. - 7:00 p.m. Committee Meetings
- 2:00 p.m. - 5:00 p.m. NE-1047 Committee Meeting
Frampton Room
- 4:30 p.m. - 5:30 p.m. Drop Off Photos for Photo Judging at Registration Desk
Prefunction Lobby
- 4:30 p.m. - 6:30 p.m. NEWSS Registration
Prefunction Lobby
- 4:30 p.m. - 6:30 p.m. NEASHS Registration
Prefunction Lobby
- 4:30 p.m. - 10:00 p.m. NEWSS / NEASHS Posters Set-Up
Ballroom A&B
- 4:30 p.m. - 10:00 p.m. Commercial Displays Set-up
Ballroom A&B
- 6:30 p.m. **Deadline for NEWSS Contest Graduate Students to Load Presentations**
- 6:30 p.m. - 8:00 p.m. NEWSS / NEASHS Student Mixer
Presidential Suite

WEDNESDAY JANUARY 4

- 7:30 a.m. Poster Judging Committee
Ballroom A&B
- 7:30 a.m. - 4:00 p.m. NEWSS Registration
Prefunction Lobby
- 7:30 a.m. - 10:00 a.m. NEASHS Registration
Prefunction Lobby
- 7:45 a.m. - 9:00 a.m. NEWSS / NEASHS
Posters (authors present)
Commercial Displays,
Coffee
Ballroom A&B
- 8:45 a.m. **Deadline** to Load NEWSS
Presentations
Prefunction Lobby
- 9:00 a.m. - 12:00 p.m. General Session and
Symposium
Society Hill Ballroom C&D
- 1:30 p.m. - 5:30 p.m. Graduate Student Session
Society Hill Ballroom C&D
- 1:30 p.m. - 2:45 p.m. Weed Biology & Ecology
Ballroom E
- 1:30 p.m. - 4:45 p.m. NEASHS Paper Session
Bromley/Claypoole Room
- 3:45 p.m. - 5:15 p.m. Ornaments
Ballroom E
- 4:45 p.m. - 5:45 p.m. NEASHS Business
Meeting and Student
Awards
Bromley/Claypoole Room

5:30 p.m. - 6:30 p.m. Student Paper Judging
Committee
Flower Room

6:30 p.m. - 8:30 p.m. NEWSS / NEASHS
Social Mixer
Hamilton

THURSDAY JANUARY 5

7:00 a.m. - 7:30 a.m. Past-Presidents' Breakfast
Taste Restaurant

7:30 a.m. - 8:15 a.m. Past-Presidents' Meeting
Taste Restaurant

8:00 a.m. - 3:00 p.m. NEWSS Registration
Prefunction Lobby

8:00 a.m. - 9:00 a.m. NEASHS Registration
Prefunction Lobby

8:00 a.m. - 8:00 p.m. NEWSS / NEASHS
Research Posters
(authors not present) &
Commercial Displays
Ballroom A&B

8:30 a.m. - 11:00 a.m. Ornaments
Ballroom E

8:30 a.m. - 11:00 a.m. Graduate Student Session
Society Hill Ballroom C&D

8:30 a.m. - 11:30 a.m. NEASHS Oral
Presentations
Bromley/Claypoole Room

10:15 a.m. - 11:45 a.m. Vegetables & Fruit
Cook

- 11:30 a.m. - 1:00 p.m. Student Paper Judging
Committee
Taste Restaurant
- 1:00 p.m. - 4:30 p.m. Symposium: Moving
beyond rotating modes of
action: Advancing the
concept and application of
integrated weed
management
Society Hill Ballroom C&D
- 1:00 p.m. - 2:30 p.m. Mini-symposium: Update
on swallow-wort ecology &
management
Ballroom E
- 2:30 p.m. - 4:30 p.m. Vegetation Management
and Restoration
Ballroom E
- 4:45 p.m. - 6:15 p.m. NEWSS Annual Business
Meeting & Awards
Society Hill Ballroom C&D
- 6:00 p.m. - 9:00 p.m. NEWSS / NEASHS Poster
Take Down
- 9:00 p.m. - 11:00 p.m. Industry Night Cap and
Dessert Social
NEWSS / NEASHS
Hamilton Room

FRIDAY JANUARY 6

- 7:00 a.m. - 7:30 a.m. Executive Committee
(Old and New) Breakfast,
Lounge

7:30 a.m. - 8:15 a.m.	Executive Committee (Old and New) Meeting, Cook Room
8:00 a.m. - 11:00 a.m.	NEWSS Registration Prefunction Lobby
8:15 a.m. - 12:00 p.m.	Agronomy Ballroom C&D
8:15 a.m. - 12:00 p.m.	Turfgrass and Plant Growth Regulators Ballroom E
12:00 p.m.	Adjourn

PROGRAM

WEDNESDAY MORNING JANUARY 4

Section: NEWSS - NEASHS POSTERS
(Authors Present)

LOCATION: Ballroom A&B
TIME: 7:45 a.m. to 9:00 a.m.
CHAIR: Kathleen Hester
IR-4 Project
Princeton, NJ

CHAIR-ELECT: Jennifer D'Appollonio
University of Maine
Orono, ME

***Presenter †Student Poster**

The Sinnemahonning Cooperative Weed Management Area (SIPMA) Gets to Work. T.J. Meyer, J. Zoschg and M.A. Bravo*, Pennsylvania Department of Agriculture, Harrisburg, PA (1)

Giant Hogweed Eradication in Pennsylvania and the United States. M.A. Bravo*, I.D. Bowers, and J. Zoschg, Pennsylvania Department of Agriculture, Harrisburg, PA (2)

†Comparing Herbicide Tolerances of Rare and Common Plants in Lancaster County, PA. I.M. Graham*, J.F. Egan, and D. Mortensen, Penn State University, University Park, PA (3)

Effect of Nozzle Type, Spray Droplet Size and Spray Volume on Crop Tolerance and Weed Control with Enlist Duo. B.D. Olson*, D.M.

Simpson, D.E. Hillger, C.C. Love, and D.T. Ellis, Dow AgroSciences LLC, Geneva, NY (4)

Modeling of Volatility of 2,4-D Ester, DMA and Choline Formulations. B.D. Olson*, D.E. Hillger, P. Havens, J.A. Huff, R.B. Lassiter, and J.S. Richburg, Dow AgroSciences LLC, Geneva, NY (5)

Methodology for Utilizing Low Tunnel Structures to Evaluate Differences in Herbicide Volatility. B.D. Olson*, D.D. Ruen, D.E. Hillger, and E.F. Scherder, Dow AgroSciences LLC, Geneva, NY (6)

†Effects of Methiozolin Rates on Creeping Bentgrass and Annual Bluegrass Root Growth. K.A. Venner*, S. Askew, and S-J. Koo, Virginia Tech, Blacksburg, VA (7)

Crop Rotation: Sequence Benefits and Problems. C.L. Mohler*, Cornell University, Ithaca, NY (8)

Herbicide Evaluation for Watermelon Grown with Plasticulture. S.A. Mathew*, B.A. Scott, and M.J. VanGessel, University of Maryland, Cambridge, MD (9)

†Evaluation of Paclobutrazol Formulations and Rates for Annual Bluegrass Control on Putting Greens. A. Post*, S. Askew, M.C. Cox, and J. Corbett, Virginia Tech, Blacksburg, VA (10)

Effect of Weed Removal Timing in Corn as Influenced by Nitrogen Source and Rate. W.J. Everman*, A. Knight, and J. Hinton, North Carolina State University, Raleigh, NC (11)

A New Pocket Scouting Guide for Aquatic Weeds. B. Lassiter, R.J. Richardson*, and G. Wilkerson, North Carolina State University, Raleigh, NC (12)

†Hairy Vetch Seedbank Persistence as Influenced by Mechanical Scarification and Soil Depth. B.C. Crockett*, S. Mirsky, and W.S. Curran, Penn State University, University Park, PA (13)

Impacts of Invasive *Ambrosia artemisiifolia* on Soil Enzyme Activity and Fertility. Q. Zhong*, X. Junfang, Q. Guoming, Z. Jia-en, M. Danjuan, and A. DiTommaso, South China Agricultural University, Guangzhou, China (14)

Physiological and Morphological Responses of Invasive *Ambrosia artemisiifolia* to Different Irradiances. M. Danjuan, Q. Zhong*, Q. Guoming, Z. Jia-en, X. Junfang, and A. DiTommaso, South China Agricultural University, Guangzhou, China (15)

Modelling the Potential Distribution of Invasive *Ambrosia artemisiifolia* in China. Q. Zhong*, A. DiTommaso, C.L. Mohler, and Z. Jia-en, South China Agricultural University, Guangzhou, China (16)

†Seedling Emergence of Several Weed Species as Affected by Furrow Location, Corn Planting Density and Pattern. F. Kordbacheh*, H.R. Mashhadi, and A. DiTommaso, University of Tehran, Tehran, Iran (17)

The Effect of Timing and the Method of Control on Japanese Stiltgrass Seed Production. J.L. Huffman*, E.S. Rauschert, A.E.

Gover, and A.N. Nord, Penn State University, University Park, PA (18)

Preliminary Characterization of Dicamba Performance in Dicamba Tolerant Soybeans in the Northeast. D.J. Mayonado*, R.L. Ritter, M.J. VanGessel, and H.P. Wilson, Monsanto, Salisbury, MD (19)

†Sweet Vernalgrass: A New Weed Problem for Northeastern Turfgrass. A.N. Smith* and S. Askew, Virginia Tech, Blacksburg, VA (20)

Weed Management with Tembotrione and Isoxaflutole in North Carolina. W.J. Everman*, J. Hinton, and M. Rosemond, North Carolina State University, Raleigh, NC (21)

†Investigating Pokeweed Management in Field Crops. K.M. Patches* and W.S. Curran. Penn State University, University Park, PA (22)

Mechanical and Cultural Effects on Lima Bean Weed Control. B.A. Scott*, M.J. VanGessel, and Q. Johnson, University of Delaware, Georgetown, DE (23)

The Weed Olympics: A National Weed Science Contest. J.T. Brosnan*, G. Armel, G.K. Breeden, J.J. Vargas, and M.J. VanGessel, University of Tennessee, Knoxville, TN (24)

†Tank Mixtures and Application Intervals for Smooth Crabgrass Control with Metamifop. M.C. Cox* and S. Askew, Virginia Tech, Blacksburg, VA (25)

Tall Fescue Tolerance to Tower® (dimethenamid) and Freehand™ (dimethenamid + pendimethalin). D. Gomez de

Barreda*, and P. McCullough, Polytechnic University of Valencia, Valencia, Spain (26)

Specialty Greens & Herbs - Surveying Ethnic Consumer Preferences for the East Coast.

R. Govindasamy, J. Simon, W. Sciarappa*, R. Van Vranken, A. Ayeni, P. Nitzsche, B. Schilling, S. Komar, V. Puduri, Rutgers University, New Brunswick, NJ; K. M. Kelley, Penn State University, University Park, PA; F. Mangan, University of Massachusetts, Amherst, MA; S. Zhang, and G. McVaoy, University of Florida, Gainesville (27)

Results of Application of Coragen® (Rynaxypyr®) on Reduction of Sunflower Moth Larvae Damage. J. Carleo*, C. A. Wyenandt, D. Ward, G. Ghidui, Rutgers University, New Brunswick, NJ and W. Autio, University of Massachusetts, Amherst, MA (28)

Education and Outreach through Gardening with Home-Schooled and Special Needs Youth. M. Cummings*, Rutgers University, New Brunswick, NJ (29)

High Tunnel Colored Bell Pepper Variety Trial – First Year Results. T. Elkner* and S. Bogash, Penn State University, University Park, PA (30)

Enabling Gardens - Rutgers and Rotary: Growing Lives One Seed at a Time. N. Polanin* and L. DePrado, Rutgers University, New Brunswick, NJ (31)

Salinity Tolerance of Sea-Beach Amaranth (*Amaranthus pumilus* Raf.) in Comparison with the Grain Amaranths (*Amaranthus cruentus* L. and *Amaranthus hypochondriacus* L.). S.W. Eisenman* and I. Zeitzer, Temple

University, Philadelphia, PA (32)

Effects of Systemm-CAL and ProGibb on PF-14 Jersey Peaches in Massachusetts and New Jersey. W. Autio, J. Krupa, University of Massachusetts, Amherst, MA.; W. Cowgill*, D. Ward, R. Magron, and S. Sollner-Figler, Rutgers University, New Brunswick, NJ (33)

Rain Gardens: Veterans Application of Horticultural Training to Storm Water Management. A. Rowe and J. Zientek*, Rutgers University, New Brunswick, NJ (34)

Oxygen and Ethylene-Induced Germination in Recalcitrant Peach Seeds. C. Frenkel*, R.D. Belding, G. Williams-Lokaj, Rutgers University, New Brunswick, NJ; and G.L. Reighard, Clemson University, Clemson, SC (35)

†Identification and Characterization of New Sources of Resistance to Eastern Filbert Blight from *Corylus avellana* Collections in Russia, Ukraine, and Poland. J. Capik*, C. Leadbetter, M. Muehlbauer, and T. Molnar, Rutgers University, New Brunswick, NJ (36)

†Patterns in Root Radial Growth of *Acer saccharinum* L. in Response to Wind Loading Patterns with Increasing Distance from the Trunk. I. Donne* and J. Grabosky, Rutgers University, New Brunswick, NJ (37)

WEDNESDAY MORNING JANUARY 4

GENERAL SESSION

LOCATION: Society Hill Ballroom C&D
TIME: 9:00 a.m. to 12:00 p.m.
MODERATOR: Antonio DiTommaso
Cornell University
Ithaca, NY

Welcome Address

Bruce A. McPheron
Dean, College of Agricultural Sciences
Penn State University
University Park, PA

Presidential Address

"I study weeds; No, seriously, I really do"
Mark VanGessel
University of Delaware
Georgetown, DE

SYMPOSIUM:

**Weed Science Funding: New
Avenues for a Changing Landscape**

Invited Speakers:

**Funding of Agricultural Programs in Land-
Grant Institutions**
Bruce A. McPheron

Dean, College of Agricultural Sciences
Penn State University
University Park, PA

**Outcome Funding and the Northeast
Sustainable Agriculture Research and
Education (SARE) Grant Program**

Thomas Morris
Professional Development Program
Northeast Sustainable Agriculture Research
and Education Program (SARE)
University of Connecticut
Storrs, CT

USDA-ARS Weed Science Funding

John Lydon
USDA, ARS, Office of National Programs
National Program Leader, Weed Science
Beltsville, MD

**Show Me the Money! Weed's Won't Wait,
Don't Hesitate**

Lee Van Wychen
Science Policy Director
National and Regional Weed Science
Societies
Alexandria, VA

WEDNESDAY AFTERNOON JANUARY 4

Section: STUDENT PRESENTATIONS

LOCATION: Society Hill Ballroom C&D
TIME: 1:30 p.m. to 5:30 p.m.
MODERATORS: Adam Smith
Virginia Tech
Blacksburg VA
Angela Post
Virginia Tech
Blacksburg VA

***SPEAKER**

- 1:30 Effect of Saflufenacil Application Timing on Soybean and its Role in Managing Glyphosate-Resistant Horseweed.** J.T. Ikley* and R.L. Ritter, University of Maryland, College Park, MD
- 1:45 Absorption, Translocation, and Metabolism of Aminocyclopyrachlor in Loblolly Pine (*Pinus taeda*).** R.L. Roten* and R.J. Richardson, North Carolina State University, Raleigh, NC
- 2:00 Control of Annual Bluegrass Biotypes With Three Postemergent Herbicides.** K.M. Han* and J.E. Kaminski, Penn State, University Park, PA

- 2:15 Herbicidal Activity of Heterocyclic Analogues of Dichlobenil on Various Weed and Ornamental Species.** J.W. Thomas*, G. Armel, M.D. Best, W.M. Klingeman, C-L. Do-Thanh, and H.E. Bostic, University of Tennessee, Knoxville, TN
- 2:30 Evaluation of Aminocyclopyrachlor for Control of Invasive Plant Species in Tennessee.** J.J. Vargas*, G. Armel, W.M. Klingeman, P. Flanagan, R.M. Evans, R.J. Richardson, and R.L. Roten, University of Tennessee, Knoxville, TN
- 2:45 Fine Fescue Varietal Tolerance to Glyphosate Rates.** M.C. Cox*, S. Askew, W. Askew, and J.M. Goatley Jr., Virginia Tech, Blacksburg, VA
- 3:00 Effects of Rooting Depth on Hybrid Bermudagrass (*C. dactylon* x *C. transvaalensis*) Injury with Indaziflam in Various Soils.** P.A. Jones*, J.T. Brosnan, G.K. Breeden, and M. Elmore, University of Tennessee, Knoxville, TN
- 3:15 Break – Coffee/Beverages on your own**
- 3:45 Effect of Corn Herbicides on Successful Cover Crop Establishment.** C.S. Dillon* and W.S. Curran, Penn State, University Park, PA
- 4:00 Partitioning Out the Effects of Nutrients from Composted Manure on Weeds and Crops.** N.G. Little*, C.L. Mohler, A. DiTommaso, and Q.M. Ketterings, Cornell University, Ithaca, NY

- 4:15 Effects of Soil Management Legacy on Weed-Crop Competition.** H.J. Poffenbarger*, S. Mirsky, J. Teasdale, J. Spargo, D. Timlin, J. Maul, and M. Cavigelli, USDA-ARS, Beltsville, MD
- 4:30 Evaluating Integrated Weed Management for No-Till Dairy Cropping Systems.** E.M. Snyder*, W.S. Curran, H.D. Karsten, and G.M. Malcolm. Penn State, University Park, PA
- 4:45 The Effect of Row Spacing on Weed Pressure, Yield and Economics in Soybean.** J.M. Orlowski*, W.J. Cox, and A. DiTommaso, Cornell University, Ithaca, NY
- 5:00 Effectiveness of Shallow High-Residue Cultivation in No-Till Soybean.** W.S. Curran and C.L. Keene*, Penn State, University Park, PA
- 5:15 Impact of Soil Moisture Content on Preemergence Weed Control Using Microwave Radiation.** A. Rana* and J.F. Derr, Virginia Tech, Blacksburg, VA
- 5:30 Adjourn**

WEDNESDAY AFTERNOON JANUARY 4

Section: WEED BIOLOGY AND ECOLOGY

LOCATION: Ballroom E
TIME: 1:30 p.m. to 2:45 p.m.
CHAIR: Jacob Barney
Virginia Tech,
Blacksburg, VA
CHAIR-ELECT: Katie Ghantous
UMass Cranberry Station
East Wareham, MA

***SPEAKER**

- 1:30 The Non-Native Vascular Flora of Monomoy Islands, Massachusetts.** R. Stalter*, St. John's University, Queens, NY
- 1:45 Compost Increases Weed Abundance in an Organic Grain Cropping System.** C.A. Marschner*, C.L. Mohler, B.A. Caldwell, and A. DiTommaso. Cornell University, Ithaca, NY
- 2:00 Initial Investigations into Dodder Species Variation in Southeastern Massachusetts.** K.M. Ghantous*, S. Stefanovic, and H.A. Sandler, UMass Cranberry Station, East Wareham, MA
- 2:15 Early Season Phenological Indicators of Cereal Rye Performance.** S. Mirsky*, J. Spargo, W. Curran, M. Ryan, and S.C. Reberg-Horton, USDA-ARS, Beltsville, MD

**2:30 Discussion, Section Business Meeting,
and Election of Chair-Elect**

WEDNESDAY AFTERNOON JANUARY 4

Section: ORNAMENTALS

LOCATION: Ballroom E
TIME: 3:45 p.m. to 5:15 p.m.
CHAIR: Chris Becker
BAAR Scientific LLC
Romulus, NY
CHAIR-ELECT: Kathleen Hester
The IR-4 Project
Exton, PA

***SPEAKER**

- 3:45 Bedding Plant Response to
Dimethenamid.** J.F. Derr*, Virginia Tech,
Virginia Beach, VA
- 4:00 Early Postemergence Control of
Bittercress (*Cardamine hirsuta*) in
Container Plant Production.** C. Marble*,
C. Gilliam, and A. Alexander, Auburn
University, Auburn, AL
- 4:15 IR-4 2011 Crop Injury Summary of
Several Herbicides on Ornamental
Nursery Crops.** K.A. Hester*, C.L.
Palmer, E. Vea, and J. Baron, IR-4
Project, Princeton, NJ

- 4:30 IR-4 2011 Summary of Postemergent Liverwort Control in Nursery Containers.** K.A. Hester*, C.L. Palmer, E. Lurvey, and J. Baron, IR-4 Project, Princeton, NJ
- 4:45 Phenoxy Herbicide Safety in Container Production of *Muhlenbergia* and *Miscanthus*.** C. Harlow* and J.C. Neal, North Carolina State University, Raleigh, NC
- 5:00 Tolerances of Container-Grown Ornamentals to Mesotrione, Dimethenamid-P, and Pendimethalin plus Dimethenamid-P Applications.** T.L. Mervosh* and J.F. Ahrens, Connecticut Agricultural Experiment Station, Windsor, CT

WEDNESDAY AFTERNOON JANUARY 4

Section: NEASHS PAPERS

LOCATION: Bromley/Claypoole
TIME: 1:30 p.m. to 4:45 p.m.
MODERATOR: Carolyn DeMoranville
NEASHS President
UMass Cranberry Station
E. Wareham, MA

***SPEAKER**

† Student Presentation

- 1:30 Nitrogen Form and Ratio Affect in Vitro Shoot Multiplication and Growth of Lowbush Blueberry (*Vaccinium angustifolium* Ait.).** J. P. Santiago and J. M. Smagula*, University of Maine, Orono, ME
- 1:45 Subsurface Tile Drainage Effects in Cranberry Production.** P. Jeranyama*, J. M. Sack, and C. DeMoranville, University of Massachusetts Amherst, Amherst, MA
- 2:00 Effects of Fertilizer Nitrogen, Magnesium, and Sulfur Rates and Sources on Fruit Skin Color in Pickling Cucumbers.** G.C. Johnson*, University of Delaware, Georgetown, DE
- 2:15 †Genetic Diversity and Population Structure of the Eastern Filbert Blight Pathogen (*Anisogramma anomala*) and its Implications on Hazelnut Breeding.** C. Leadbetter*, J. Capik, G. Cai, B. Hillman, and T. Molnar. Rutgers University, New Brunswick, NJ
- 2:30 †Overcoming the Challenges to Switchgrass Production on Small Farms as a Source for Alternative Energy.** W.T. Hlubik, J. Baculis*, S. Bonos, Z. Helsen, and R. Weidman, Rutgers University, New Brunswick, NJ
- 2:45 †Patterns in Root Radial Growth of *Acer saccharinum* L. in Response to Wind Loading Patterns with Increasing Distance from the Trunk.** I. Donne* and J. Grabosky, Rutgers University, New Brunswick, NJ

- 3:00 †Maximum Tree Size for Species of Urban Trees in Northern New Jersey Communities.** J. Sanders* and J. Grabosky, Rutgers University, New Brunswick, NJ
- 3:15 Break – Coffee/Beverages on your own**
- MODERATOR: W.T. Hlubik, NEASHS
President-Elect
- 3:45 Ten-Year Performance of Three Dwarf Apple Rootstocks with Cameo™ Apple.** J.M. Clements, W.R. Autio, University of Massachusetts; W. Cowgill*, and D. Ward, Rutgers University, New Brunswick, NJ
- 4:00 Harvest Characteristics and Other Attributes of Fall Broccoli.** M. Infante-Casella*, M. Henninger, and M. Cummings, Rutgers University, New Brunswick, NJ
- 4:15 Red Pepper Cultivar Evaluations for the Summer and Fall Market.** W. Kline* and C.A. Wyenandt, Rutgers University, New Brunswick, NJ
- 4:30 Characterizing Plant Architecture in 3D Using Magnetic Data Acquisition and Multi-Scale Graph Analysis.** J.S. Caplan*, C.A. Faillace, J. Lafond, J. Grabosky, and J.G. Ehrenfeld (deceased), Rutgers University, New Brunswick, NJ
- 4:45 NEASHS Business Meeting and Student Awards**

5:45 Adjourn

WEDNESDAY EVENING JANUARY 4

NEWSS / NEASHS SOCIAL

LOCATION: Hamilton Room
TIME: 6:30 p.m. to 8:30 p.m.

THURSDAY MORNING JANUARY 5

Section: STUDENT PRESENTATIONS

LOCATION: Society Hill Ballroom C&D
TIME: 8:30 a.m. to 11:00 a.m.
MODERATORS: Katherine Ghantous
University of Massachusetts
Amherst, MA
Neith Little
Cornell University
Ithaca, NY

***SPEAKER**

**8:30 Invasive Potential of Bioenergy Crops
Using the New APHIS Assessment:
How Risky is Renewable Energy? L.L.
Smith* and J.N. Barney, Virginia Tech,
Blacksburg, VA**

- 8:45** **Investigations of Potential Biological and Chemical Controls for Silvery Thread Moss on Putting Greens.** A. Post*, S. Askew, and D. McCall, Virginia Tech, Blacksburg, VA
- 9:00** **Natural History Survey of the "Invasive" *Miscanthus sinensis* Populations of Eastern North America.** R.F. Dougherty*, L. Quinn, T. Voigt, B. Endres, and J.N. Barney, Virginia Tech, Blacksburg, VA
- 9:15** **Do Deer Browse on Invasive Exotic Plants? Deer Preference Trial Results For Native and Invasive Exotic Plants in Pennsylvania.** K.M. Averill* and D. Mortensen, Penn State, University Park, PA
- 9:30** **Economics, Efficacy, and Non-Target Effects of Managing the Forest Understory Invader *Microstegium vimineum*.** D. Tekiela*, A. Post, S. Askew, and J.N. Barney, Virginia Tech, Blacksburg, VA
- 9:45** **Coffee Break**
- 10:15** **Nitrogen-Enhanced Efficacy of Mesotrione and Topramezone for Smooth Crabgrass (*Digitaria ischaemum*) Control.** M. Elmore*, J.T. Brosnan, G.K. Breeden, and P.A. Jones, University of Tennessee, Knoxville, TN
- 10:30** **Quantifying Vapor Drift of Dicamba Herbicides Applied to Soybean.** J.F. Egan* and D. Mortensen, Penn State, University Park, PA

10:45 Nicosulfuron-Resistant Johnsongrass Exhibits Differential Sensitivity to Glyphosate. A.N. Smith* and E.S. Hagood, Virginia Tech, Blacksburg, VA

THURSDAY MORNING JANUARY 5

Section: ORNAMENTALS

LOCATION: Ballroom E
TIME: 8:30 a.m. to 11:00 a.m.
CHAIR: Chris Becker
BAAR Scientific LLC
Romulus, NY
CHAIR-ELECT: Kathleen Hester
The IR-4 Project
Exton, PA

***SPEAKER**

- 8:30 Postemergence Control of Monocotyledonous Weeds in Selected Container-Grown Ornamentals.** A.F. Senesac*, Cornell University, Riverhead, NY
- 8:45 Safety and Efficacy of Mulch and Mulch / Herbicide Combinations in Pansy Beds.** J.C. Neal*, C. Harlow, and B. Fair, North Carolina State University, Raleigh, NC
- 9:00 Spray Volume and Droplet Size Affect Herbicide Deposition on Container Surfaces.** J. Atland* and R. Derksen, USDA-ARS, Wooster, OH

- 9:15 Tolerance of Conifers to Mesotrione Alone or Combined with Other Herbicides.** J.F. Ahrens* and T.L. Mervosh, Connecticut Agricultural Experiment Station, Windsor, CT
- 9:30 Section Business Meeting, and Election of Chair-Elect**
- 9:45 Coffee Break**
- 10:15 IR-4 Project Priority Discussion**
- 11:00 Adjourn**

THURSDAY MORNING JANUARY 5

Section: NEASHS PAPERS

LOCATION: Bromley/Claypoole
TIME: 8:30 a.m. to 11:30 a.m.
MODERATOR: Nick Polanin NEASHS
Secretary/Treasurer

***SPEAKER**

- 8:30 Sustainable Cranberry Production with Reduced Phosphorus Applications.** C. DeMoranville*, University of Massachusetts Amherst, Amherst, MA

- 8:45 Control of Downy Mildew (*Pseudoperonospora cubensis*) in Organically -Produced Cucumber with Biopesticides.** M.T. McGrath, G.M. Fox, and L.K. Hunsberger*, Cornell University, Riverhead, NY
- 9:00 Lima Bean Breeding and Genetics Research at the University of Delaware.** E.G. Ernest,* T.A. Evans, N.F. Gregory, and R.J. Wisser, University of Delaware, Georgetown, DE
- 9:15 Evaluating Cranberry Progeny for Field Fruit Rot Resistance.** J. Johnson-Cicalese*, N. Vorsa, J. Polashock, L. Georgi, and M. Tadych, Rutgers University and USDA-ARS, New Brunswick, NJ
- 9:30 Annie's Project NJ – Helping Women Farmers Take the Risk Out of Farm Management.** J. Carleo*, R. Brumfield, B. O'Neill, N. Polanin, S. Komar, and R. Mickel, Rutgers University, New Brunswick, NJ
- 9:45 Coffee Break**
- 10:15 Progress in Understanding Cold-Hardiness, Acclimation, and Deacclimation in Diverse Blueberry Germplasm.** M.K. Ehlenfeldt*, L.J. Rowland, E.L. Ogden, and B. Vinyard. USDA-ARS, Marucci Center for Blueberry and Cranberry Research and Extension, Chatsworth, NJ

- 10:30 Ornamental Plant Breeding in the Private Sector.** J. Janes*, M. Scheiber, and M. Dobres, NovaFlora Inc., West Grove, PA
- 10:45 Proanthocyanidin Content and Composition in the Cranberry Ovary from Flower to Mature Fruit: The Potential Role in Fruit Rot Resistance.** N. Vorsa*, J. Johnson-Cicalese, S. Shah, and A. Singh, Rutgers University, New Brunswick, NJ
- 11:00 Specialty Greens and Herbs - Surveying Ethnic Consumer Preferences for the East Coast.** R. Govindasamy, J. Simon, W. Sciarappa*, R. Van Vranken, A. Ayeni, P. Nitzsche, B. Schilling, S. Komar, and V. Puduri, Rutgers University; K.M. Kelley, Penn State University; F. Mangan, University of Massachusetts; Shouan Zhang and G. McVaoy, University of Florida
- 11:15 Injury from Delayed Applications of Dichlobenil on Four Cranberry Varieties.** H.A. Sandler*, UMass Cranberry Station, East Wareham, MA
- 11:30 Adjourn**

THURSDAY MORNING JANUARY 5

Section: FRUITS AND VEGETABLES

LOCATION: Cook Room
TIME: 10:15 a.m. to 11:45 p.m.
CHAIR: Rick Dunst
Cornell University
Portland, NY
CHAIR-ELECT: Dan Kunkel
Rutgers University
Princeton, NJ

***SPEAKER**

- 10:15 Fruit Tree Tolerance to Alion™
Herbicide.** M. Mahoney*, D. Unland, and
B. DeWeese. Bayer CropScience,
Oxford, MD
- 10:30 The IR-4 Project: Update on Weed
Control Projects (Food Uses).** M.
Arsenovic*, D. Kunkel, and J. Baron, IR-4
Project, Princeton, NJ
- 10:45 Sweet Corn Weed Control: No-till, No
Atrazine, No Way?** D.D. Lingenfelter*,
M.J. VanGessel, B.A. Scott, and Q.
Johnson, Penn State, University Park, PA
- 11:00 Sulfentrazone For Lima Beans: Are We
Charging Forward?** M.J. VanGessel*,
B.A. Scott, and Q. Johnson, University of
Delaware, Georgetown, DE

- 11:15 Preemergent Combinations of Herbicides for Weed Control in Wild Blueberry Fields.** D.E. Yarborough* and J.L. D'Appollonio, University of Maine, Orono, ME
- 11:30 Discussion, Section Business Meeting, and Election of Chair-Elect**
- 11:45 Adjourn**

THURSDAY AFTERNOON JANUARY 5

Section: VEGETATION MANAGEMENT AND RESTORATION

- LOCATION: Ballroom E
TIME: 1:00 p.m. to 4:30 p.m.
CHAIR: Brian McDonnell
National Park Service
Bushkill, PA
CHAIR-ELECT: Jon Johnson
Penn State
University Park, PA

***SPEAKER**

Swallow-wort Mini-Symposium

- 1:00 The Swallow-worts: Where to Next?** A. DiTommaso*, Cornell University, Ithaca, NY
- 1:20 Pale and Black Swallow-wort Growth and Survival in New York State.** K.M. Averill* and A. DiTommaso, Penn State University, University Park, PA

- 1:40 Approaches for Swallow-wort Control - Deciding How to Begin.** N.P. Cain* and T.L. Mervosh, Cain Vegetation, Acton, ON
- 2:00 Swallow-wort (*Vincetoxicum* spp.) Biological Control Update.** L.R. Milbrath*, USDA-ARS, Ithaca, NY
- 2:20 Panel Discussion**
- 2:30 Goatsrue Control Program in Pennsylvania.** M.A. Bravo*, J. Zoschg, L. Ross, and I. Bowers, Pennsylvania Department of Agriculture, Harrisburg, PA
- 2:45 Comparison of Herbicides for Early Season Control of Mile-a-Minute and Impact on Non-Target Vegetation.** A.E. Gover* and J. Huffman, Penn State, University Park, PA
- 3:00 Break – *Coffee/Beverages on your own***
- 3:30 F9007: A New Herbicide for Weed Control in Pasture and Wheat.** J.P. Reed*, T. Mize, G. Stratman, and B. Neuberger, FMC, North Little Rock, AR
Break – *Coffee/Beverages on your own*
- 3:45 Absorption and Translocation of ¹⁴C-Aminocyclopyrachlor in Three Aquatic Species.** R.L. Roten* and R.J. Richardson, North Carolina State University, Raleigh, NC
- 4:00 Turion Biology of Monoecious *Hydrilla verticillata*.** R.J. Richardson* and S. Hoyle, North Carolina State University, Raleigh, NC

**4:15 Discussion, Section Business Meeting,
and Election of Chair-Elect**

4:30 Adjourn

THURSDAY AFTERNOON JANUARY 5

SYMPOSIUM

**Moving Beyond Rotating Modes of Action:
Advancing the Concept and Application of
Integrated Weed Management**

LOCATION: Ballroom C&D
TIME: 1:00 p.m. to 4:30 p.m.
MODERATORS: Richard Smith
University of New Hampshire
Durham, NH
Matthew Ryan
Penn State
University Park, PA

***SPEAKER**

**1:00 Diversification, Soil Quality and
Integrated Weed Management.** E.R.
Gallandt*, University of Maine, Orono, ME

**1:30 Clashing Perspectives Limit IWM
Adoption in the Northeast.** D.D.
Lingenfelter*, Penn State, University Park,
PA

2:00 IWM: What the Heck is That? J.L.
Lindquist*, University of Nebraska,
Lincoln, NE

- 2:30 Interactions that Matter: Improving Efficacy with Strategic Combinations of Cultural Weed Management Practices.** M.R. Ryan*, D. Mortensen, J. Teasdale, R. Smith, S. Mirsky, and W. Curran, Penn State, University Park, PA
- 3:00 Break – *Coffee/Beverages on your own***
- 3:30 Are Organic Farming and Herbicide Resistance the Last Hopes for IWM? A View from Canada.** S. Shirliffe*, University of Saskatchewan, Saskatoon, SK
- 4:00 Why are We Still Talking About Weeds? Addressing the Roots of a Perennial Problem.** R.G. Smith*, University of New Hampshire, Durham, NH

THURSDAY AFTERNOON JANUARY 5

NEWSS 66th ANNUAL BUSINESS MEETING AND AWARDS

LOCATION: Society Hill Ballroom C&D

TIME: 4:45 p.m. to 6:15 p.m.

Call to order: M. VanGessel

Acceptance of the Minutes from the 65th Annual Business Meeting

NEWSS Awards

Presenter: Hilary Sandler
UMass Cranberry Station
East Wareham, MA

Award of Merit

Dr. Ronald L. Ritter

Fellow Award

Dr. Timothy Dutt

Service Recognition Award

Ms. Sherrilynn Novak

Robert D. Sweet Outstanding Graduate Student Award

Matthew A. Cutulle (Ph.D.)

Jose Javier Vargas (M.S.)

Awards Committee Reports:

- Collegiate Weed Contest Winners - G. Armel
- Graduate Student Presentation Awards - H. Sandler
- Research Poster Contest - Q. Johnson
- Photo Contest - G. Armel

Necrology Report - M. Bravo

Executive Committee Reports (available on web)

President's Comments - M. VanGessel

Secretary/Treasurer Update - M. Bravo

Audit Committee Report - J. Steffel

Archive Report - D. Kunkel

CAST Update – R. Prostack

Other Old Business

Officer Changeover and Presentation of the Gavel

New Business - A. DiTommaso

Resolutions

Nominating Committee Report - D. Yarborough
Election of the Vice President

Appointment (2) and Election (3) of the 2012
Nominating Committee

Resolution Committee Appointments

Weed Contest 2012 - TBD

WSSA 2012 Annual Meeting – J. Barney

Change of Treasurer/Secretary to two positions,
Treasurer and Membership Committee

Announcement: Poster Take Down

Next Meeting: February 4-7, 2013
Monday through Thursday
Location: Hilton, Baltimore, MD

Adjourn

THURSDAY EVENING JANUARY 5

INDUSTRY NIGHT CAP
AND DESSERT
NEWSS / NEASHS SOCIAL

LOCATION: Hamilton Ballroom
TIME: 9:00 p.m. to 11:00 p.m.

SPONSORED BY:
BASF Corp.
Bayer CropScience
FMC
Monsanto
PBI Gordon
Syngenta

FRIDAY MORNING JANUARY 6

Section: TURFGRASS AND PLANT
GROWTH REGULATORS

LOCATION: Ballroom E
TIME: 8:15 a.m. - 12:00 p.m.
CHAIR: James Brosnan
University of Tennessee
Knoxville, TN
CHAIR-ELECT: Aaron Patton
Purdue University
West Lafayette, IN

***SPEAKER**

- 8:15 Methiozolin Programs for Annual Bluegrass Control in Creeping Bentgrass Putting Greens in Tennessee.** J.T. Brosnan* and G. Breeden, University of Tennessee, Knoxville, TN
- 8:30 Annual Bluegrass Control on Golf Putting Greens with Spring Applications of Methiozolin.** S. Askew* and S.-J. Koo, Virginia Tech, Blacksburg, VA

- 8:45 Use of Methiozolin for Annual Bluegrass (*Poa annua* L.) Control on Creeping Bentgrass (*Agrostis stolonifera*) Greens.** K.A. Venner*, S. Hart, S. Askew, and C. Mansue, Rutgers University, New Brunswick, NJ
- 9:00 Seedhead Suppression of an Annual Bluegrass Putting Green.** J. Borger*, M. Naedel, and K. Hivner, Penn State University, University Park, PA
- 9:15 Ground Ivy Control as Affected by Mowing Prior to or Following Herbicide Applications.** A.J. Patton* and D. Weisenberger, Purdue University, West Lafayette, IN
- 9:30 Broadleaf Weed Control in Turfgrass Using Alternatives to Synthetic Herbicides.** D. Linde* and S. McDonald, Delaware Valley College, Doylestown, PA
- 9:45 Use of Environmental Genomics for Natural Products Discovery of Novel Herbicides.** J.T. Kao-Kniffin*, Cornell University, Ithaca, NY
- 10:00 Coffee Break**
- 10:30 Influence of Early Applications on Annual Bluegrass Seedhead Suppression with Ethephon and Mefluidide.** S. Askew* and A. Smith, Virginia Tech, Blacksburg, VA

- 10:45 Tall Fescue (*Festuca arundinacea*) Tolerance to Spring and Fall Amicarbazone Applications.** G.K. Breeden*, J. Brosnan, and P. McCullough, University of Tennessee, Knoxville, TN
- 11:00 Mesotrione and Amicarbazone Combinations for Annual Bluegrass (*Poa annua*) Control.** M.T. Elmore*, J. Brosnan, and G. Breeden, University of Tennessee, Knoxville, TN
- 11:15 Potential Antagonism of Sulfentrazone and Fenoxaprop Tank-Mixes for Goosegrass Control.** A.J. Patton*, D. Weisenberger, J. Brosnan, and G. Breeden, Purdue University, West Lafayette, IN
- 11:30 Cool-Season Turfgrass Reseeding Intervals for Methiozolin.** P. McCullough and D. Gomez de Barreda*, University of Georgia, Griffin, GA
- 11:45 Discussion, Section Business Meeting, and Election of Chair-Elect**
- 12:00 Adjourn**

FRIDAY MORNING JANUARY 6

Section: AGRONOMY

LOCATION: Society Hill Ballroom C&D
TIME: 8:15 a.m. - 12:00 p.m.
CHAIR: Keith Burnell
Syngenta Crop Protection
Penfield, NY
CHAIR-ELECT: Richard Richtmyer
Cornell University
Ithaca, NY

***SPEAKER**

- 8:15 Enlist Corn Tolerance and Weed Control with PRE Followed by POST Herbicide Programs.** B.D. Olson*, S. Ditmarsen, C. Gallup, M. Melichar, and P. Prasifka, Dow AgroSciences LLC, Geneva, NY
- 8:30 Reduced Rate Residual Herbicides Prevent Dandelion Establishment in Zone-Tillage Corn and Soybeans.** R.R. Hahn*, R. Richtmyer III, and J. Orłowski, Cornell University, Ithaca, NY
- 8:45 Zemax™: A New Mesotrione plus S-metolachlor Formulation in Corn.** E. Hitchner*, R. Lins, M. Urwiler, and G. Vail, Syngenta Crop Protection, Elmer, NJ

- 9:00 Performance of F9310 and F9316 in the Northeast PRE and POST Corn Trials in 2010 and 2011.** J.P. Reed*, J.S. Wilson, G.G. Stratman, B.A. Neuberger, and T.W. Mize, FMC Corporation, Philadelphia, PA
- 9:15 Exploring Opportunities to Diversify Burndown Options in No-till Crop Production Systems.** W.S. Curran* and D. Lingenfelter, Penn State, University Park, PA
- 9:30 Defining Geographic and Bioclimatic Distributions of Troublesome Weeds in Grain Crops.** E.M. Buck*, A. DiTommaso, S.J. Riha, and A.J. McDonald, Cornell University, Ithaca, NY
- 9:45 Herbicide Resistance Education - A Critical Step in Proactive Management.** W.J. Everman*, L. Glasgow, L. Ingegneri, J. Schroeder, D. Shaw, J. Soteres, J. Stachler, and F. Tardif, North Carolina State University, Raleigh, NC
- 10:00 Coffee Break**
- 10:30 Stewardship of Dicamba in Dicamba-Tolerant Cropping Systems.** W.E. Thomas*, S. Bowe, L. Bozeman, M. Staal, T. Cannan, and S. Murdock, BASF Corporation, Triangle Park, NC
- 10:45 Efficacy of F9310 and Sulfentrazone Premixes in the Northeast Soybean Trials in 2011.** J.P. Reed*, J.S. Wilson, G. G. Stratman, B.A. Neuberger, and T. W. Mize, FMC Corporation, Philadelphia, PA

- 11:00 Update on HPPD-Resistant Waterhemp and Control Options in Corn and Soybeans.** K.D. Burnell*, V.K. Shivrain, A. Franssen, and G. Vail, Syngenta Crop Protection, Penfield, NY
- 11:15 Selectivity of Glyphosate and HPPD Inhibiting Herbicides in a New Soybean Event.** M. Mahoney*, J. Allen, and J. Hinz, Bayer CropScience, Oxford, MD
- 11:30 Anthem™ and Anthem ATZ™ -Two New Herbicides for Pre-emergence and Post-emergence Control of Key Broadleaf and Grass Weed Pests.** J.S. Wilson*, T.W. Mize, T. Martin, J.P. Reed, G.G. Stratman, and B.A. Neuberger, FMC Corporation, Philadelphia, PA
- 11:45 Discussion, Section Business Meeting, and Election of Chair-Elect**
- 12:00 Adjourn**

INDEX OF HERBICIDES MENTIONED IN THE 2012 PROGRAM

<u>Common Name</u>	<u>Trade Name</u>
2,4-D	many
amicarbazone	Dinamic
aminocyclopyrachlor	Imprelis
aminopyralid	Milestone
atrazine	Aatrex, many
bensulide	Bensumec, Prefar
bentazon	Basagran
bispyribac-sodium	Regiment, Velocity
clopyralid	Lontrel, Stinger, Transline
dicamba	Banvel, many
dichlobenil	Barrier, Casoron, others
dichlorprop	Weedone 2,4-DP
dimethenamid-p	Outlook, Tower
dithiopyr	Dimension
diuron	Karmex
fenoxaprop	Acclaim, Horizon, others
fluazifop-p	Fusilade, Ornamec, others
flumioxazin	BroadStar, Chateau, Valor
fluthiacet-methyl	Cadet
fomesafen	Reflex
glufosinate	Finale, Ignite, Rely
glyphosate	Glyphomax, Glyphos, Roundup
.....	Touchdown, many
halosulfuron	Sandea, SedgeHammer
hexazinone	Pronone, Velpar
imazamox	ClearCast, Raptor, Odessey
imazapic	Cadre, Plateau
imazapyr	Arsenal, Habitat, others
indaziflam	Alion, Specticle
isoxaben	Gallery
isoxaflutole	Balance flexx
linuron	Linex, Lorox
mecoprop (MCP)	various
mefluidide	Embark, Vistar
mesotrione	Callisto, Tenacity
metsulfuron	Ally, Cimarron, Escort, others
nicosulfuron	Accent

oxadiazon	Ronstar
pelargonic acid.....	Scythe, others
pendimethalin	Prowl, Pendulum
prodiamine.....	Barricade, Factor
rimsulfuron.....	Matrix, Resolve, others
saflufenacil.....	Sharpen, Treevix, Kixor
sethoxydim	Poast, Segment, others
s-metolachlor	Dual Magnum, Medal, others
sulfentrazone	Authority, Dismiss, Spartan
sulfometuron-methyl.....	Oust
sulfosulfuron	Outrider, Maverick
tembotrione.....	Laudis
terbacil	Sinbar
topramezone.....	Impact
triclopyr	Garlon, Turflon
trifluralin	Treflan, many

COMBINATION PRE-MIX HERBICIDES

FreeHand.....dimethenamid-P + pendimethalin
SureStart.....acetochlor + clopyralid + flumetsulam

PLANT GROWTH REGULATORS

Common Name Trade Name

ethephon..... Ethrel, Florel
paclobutrazol Bonzi, Clipper, Trimmit
trinexapac-ethyl Palisade, Primo

EXPERIMENTAL HERBICIDES

Anthem.....F9310, pyroxasulfone + fluthiacet-methyl
Anthem ATZ.....F9316, pyroxasulfone + atrazine +
fluthiacet-methyl
Enlist Duo.....2,4-D choline + glyphosate DMA
..... methiozolin
F9007.....carfentrazone + metsulfuron
Zemax.....mesotrione + s-metolachlor

Information on herbicide common and trade names used in the program was obtained from **WSSA Herbicide Handbook, 9th Edition 2007**, edited by **S.A. Senseman**, and is provided as a courtesy to meeting attendees.

Trade names may change; interested persons should confirm active trade names with company representatives if desired.

Personal Time Schedule

Time	Wednesday	Thursday	Friday
8:00			
8:15			
8:30			
8:45			
9:00			
9:15			
9:30			
9:45			
10:00			
10:15			
10:30			
10:45			
11:00			
11:15			
11:30			
11:45			
Noon			
1:00			
1:15			
1:30			
1:45			
2:00			
2:15			
2:30			
2:45			
3:00			
3:15			
3:30			
3:45			
4:00			
4:15			
4:30			
4:45			
5:00			
5:45			
6:00			
6:30			

NEWS PAST PRESIDENTS

GILBERT H. AHLGREN	1947-49
ROBERT D. SWEET	1949-50
HOWARD L. YOWELL.....	1950-51
STEPHEN M. RALEIGH.....	1951-52
CHARLES E. MINARIK.....	1952-53
ROBERT H. BEATTY.....	1953-54
ALBIN O. KUHN.....	1954-55
JOHN VAN GELUWE	1955-56
L. DANIELSON.....	1956-57
CHARLES L. HOVEY.....	1957-58
STANFORD N. FERTIG.....	1958-59
GORDON UTTER.....	1959-60
E. M. RAHN.....	1960-61
LAWRENCE SOUTHWICK.....	1961-62
DONALD A. SHALLOCK.....	1962-63
ANTHONY J. TAFURO.....	1963-64
ROBERT A. PETERS.....	1964-65
GIDEON D. HILL.....	1965-66
RICHARD D. ILNICKI.....	1966-67
JOHN E. GALLAGHER.....	1967-68
JOHN A. MEADE.....	1968-69
HOMER M. LEBARON.....	1969-70
JOHN F. AHRENS.....	1970-71
GEORGE H. BAYER.....	1971-72
ARTHUR BING.....	1972-73
RALPH HANSEN.....	1973-74
WALTER A. GENTNER.....	1974-75
HENRY P. WILSON.....	1975-76
RICHARD J. MARRESE.....	1976-77
C. EDWARD BESTE.....	1977-78
JAMES D. RIGGLEMAN.....	1978-79
JAMES V. PAROCHETTI.....	1979-80
M. GARRY SCHNAPPINGER.....	1980-81
RAYMOND B. TAYLORSON.....	1981-82
STEPHAN DENNIS.....	1982-83
THOMAS L. WATSCHKE.....	1983-84
JAMES C. GRAHAM.....	1984-85
RUSSELL R. HAHN.....	1985-86
EDWARD R. HIGGINS.....	1986-87
MAXWELL L. MCCORMACK, JR.....	1987-88
ROY R. JOHNSON.....	1988-89
STANLEY F. GORSKI.....	1989-90
JOHN B. DOBSON.....	1990-91
PRASANTA C. BHOWMIK.....	1991-92

STANLEY W. PRUSS	1992-93
RONALD L. RITTER	1993-94
WAYNE G. WRIGHT	1994-95
BRADLEY A. MAJEK	1995-96
THOMAS E. VRABEL	1996-97
JOSEPH C. NEAL	1997-98
DAVID B. VITOLO	1998-99
A. RICHARD BONANNO	1999-00
BRIAN D. OLSON	2000-01
JEFFREY F. DERR	2001-02
DAVID J. MAYONADO	2002-03
D. SCOTT GLENN	2003-04
ROBIN R. BELLINDER	2004-05
TIMOTHY E. DUTT	2005-06
WILLIAM S. CURRAN	2006-07
RENEE J. KEESE	2007-08
JERRY J. BARON	2008-09
DAVID E. YARBOROUGH	2009-10
HILARY A. SANDLER	2010-11

NOTES

NOTES

NOTES

NOTES

NOTES

NOTES